

ZAZA2 PLS5

AVANTAGES! 36H3@F397E

- Plus compact
- Facile et simple à installer
- Réglage rapide

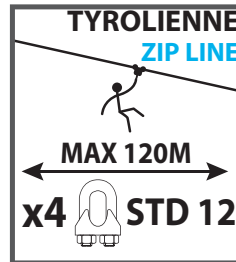
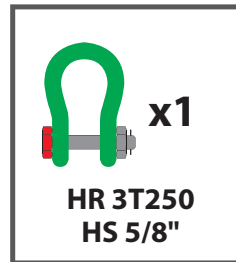
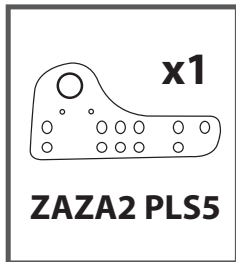
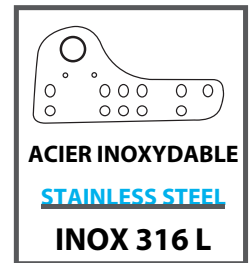
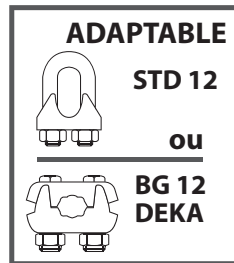
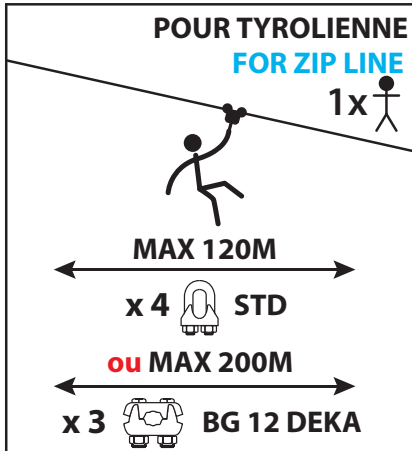

OU

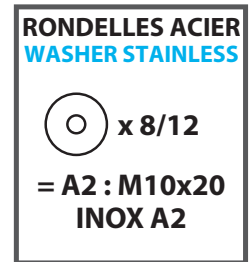
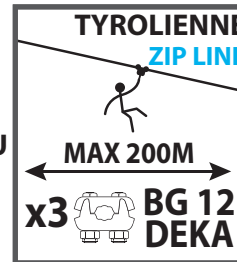

EXEMPLES DE SYSTEMES DE FIXATIONS
SYSTEM OF FIXING

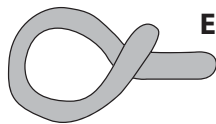

ELINGUE RONDE TEXTILE TYPE "E"
ROUND TEXTILE SLING TYPE "E"

NORMES : EN 13411-1/7:2011
STANDARDS:

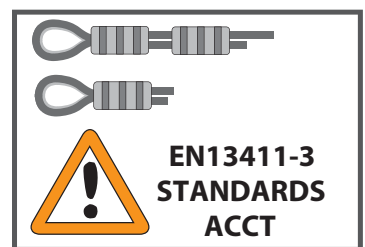
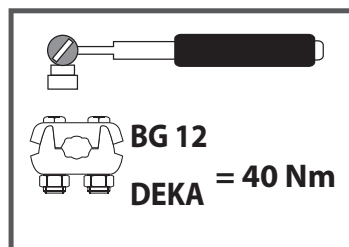
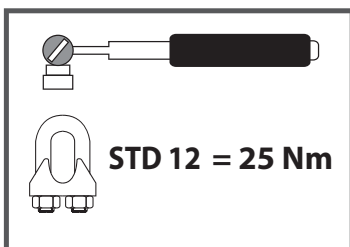
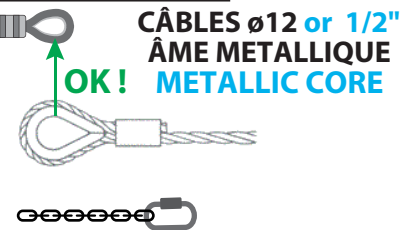
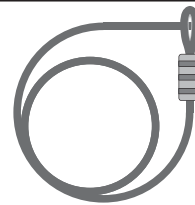
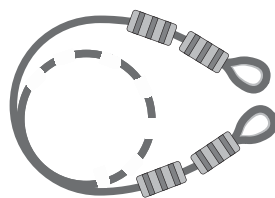

Operation 1

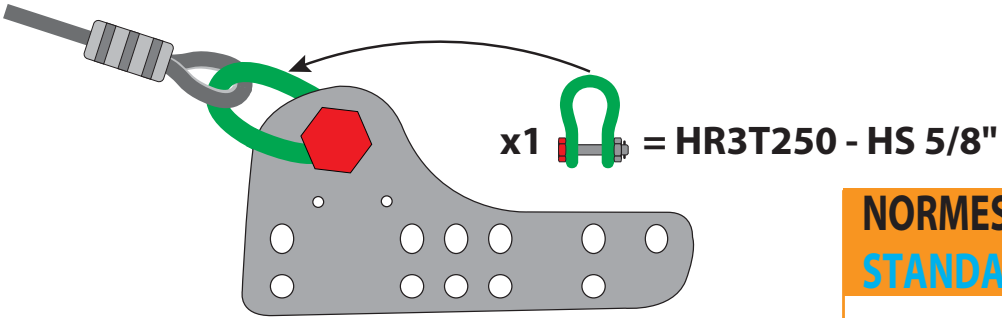

**NORMES DE MONTAGE
STANDARDS OF ASSEMBLY**



EN 15567-1:2015
EN 13411-1/7:2011
STANDARDS - ACCT

Operation 2

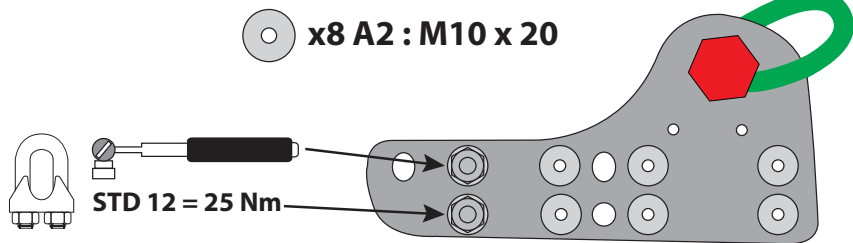
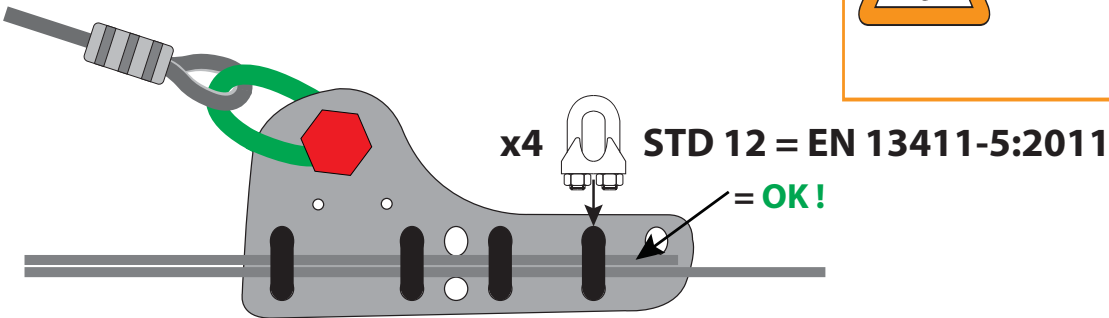

Operation 3

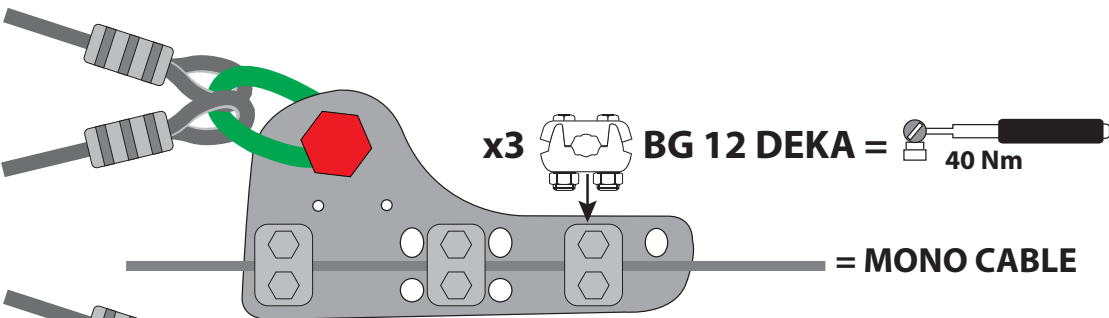

CÂBLE TYROLIENNE

ZIP LINE CABLE

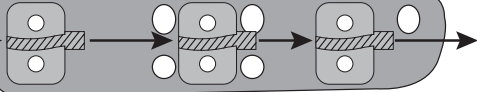

(2x6)=12 A2 : M10 x 20
= bon couple de serrage
= good tightening torque

Operation 4



= OBSERVER LE SENS DE CIRCULATION DU CROCHET
OBSERVE THE DIRECTION OF CIRCULATION OF THE SAFETY HOOK

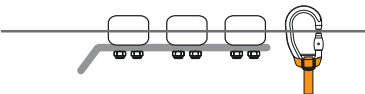

- **PLATINE DE DEPART : ZAZA2 PLS3**
STARTING PLATE: ZAZA2 PLS3

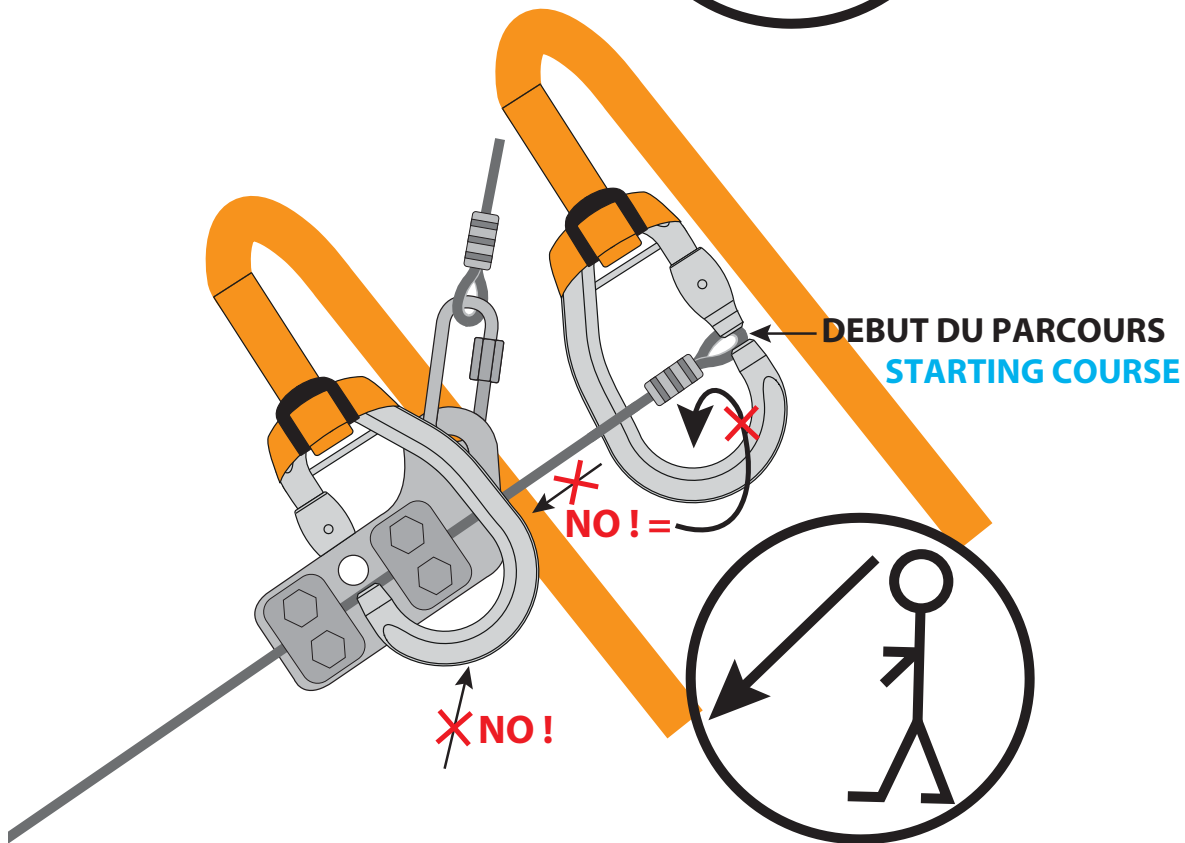
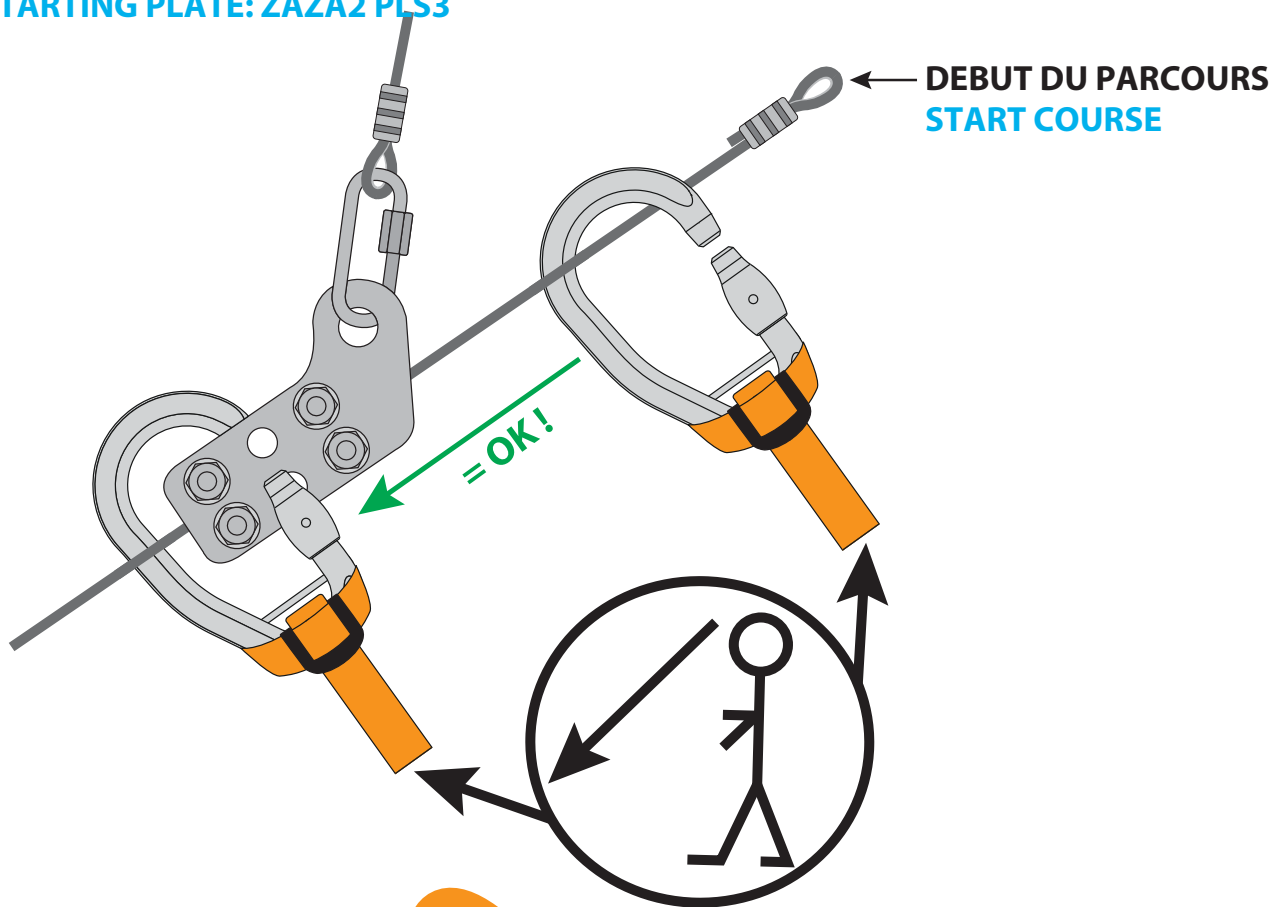

• STARTING PLATE : ZAZA2 PLI

AU CENTRE = 1 x 
 IN CENTER

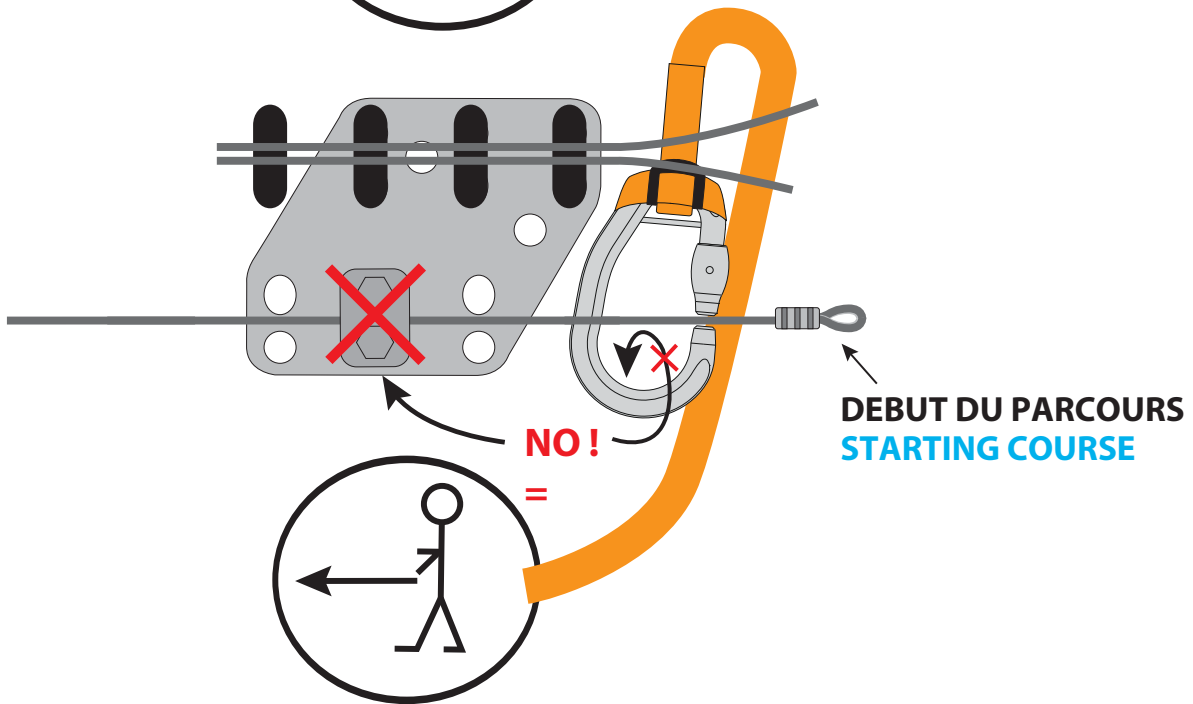
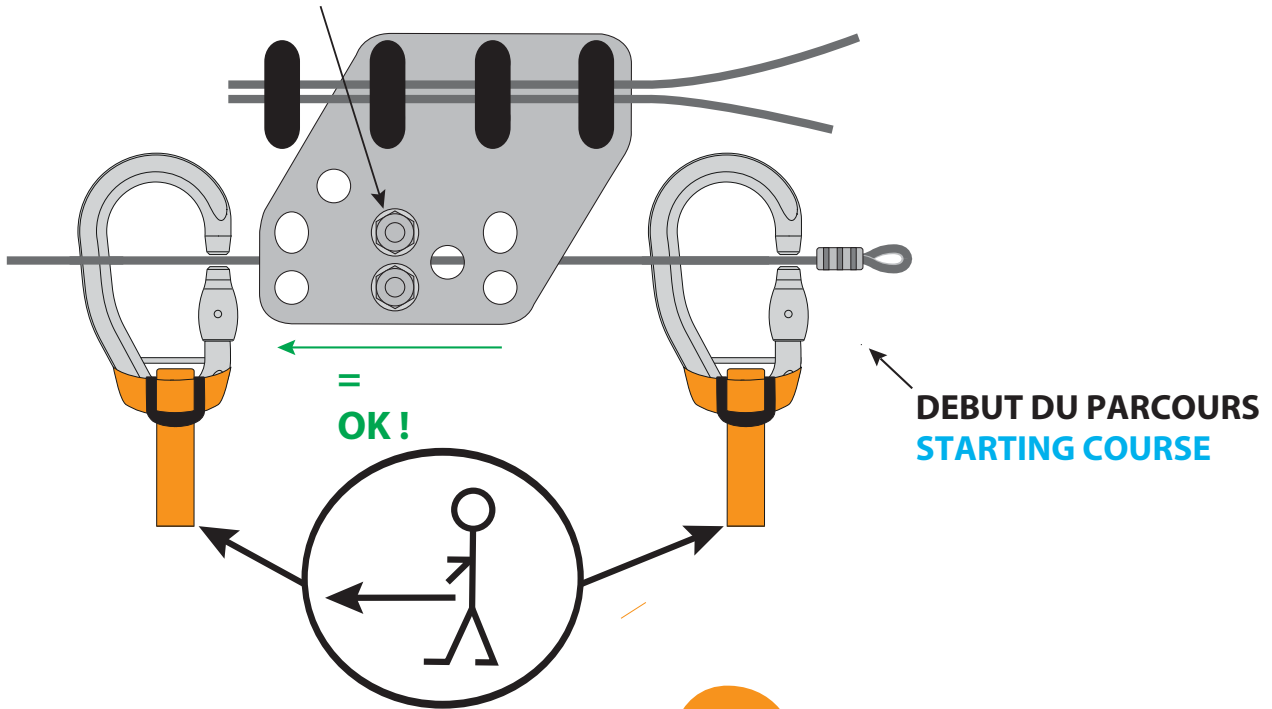

= OBSERVER LE SENS DE CIRCULATION DU CROCHET
 OBSERVE THE DIRECTION OF CIRCULATION OF THE SAFETY HOOK

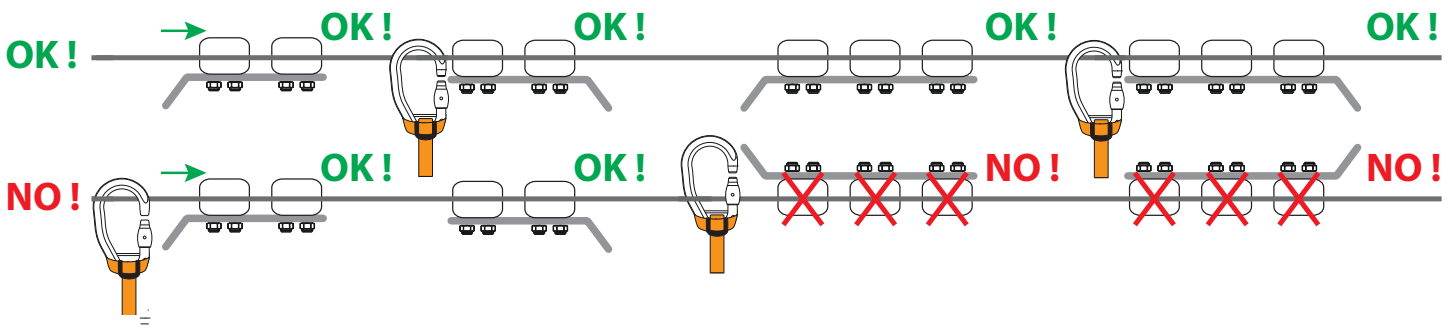

Operation 5

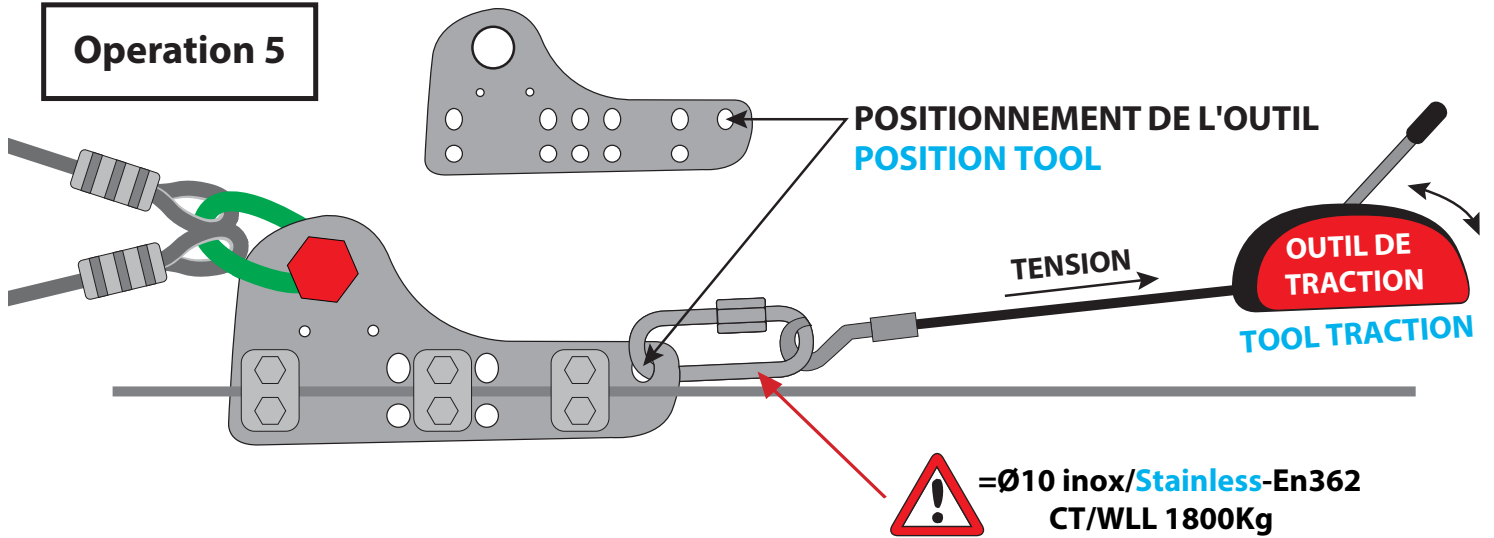

Operation 6

● **RECOMMANDATION DE MONTAGE
RECOMMENDATION ASSEMBLY**

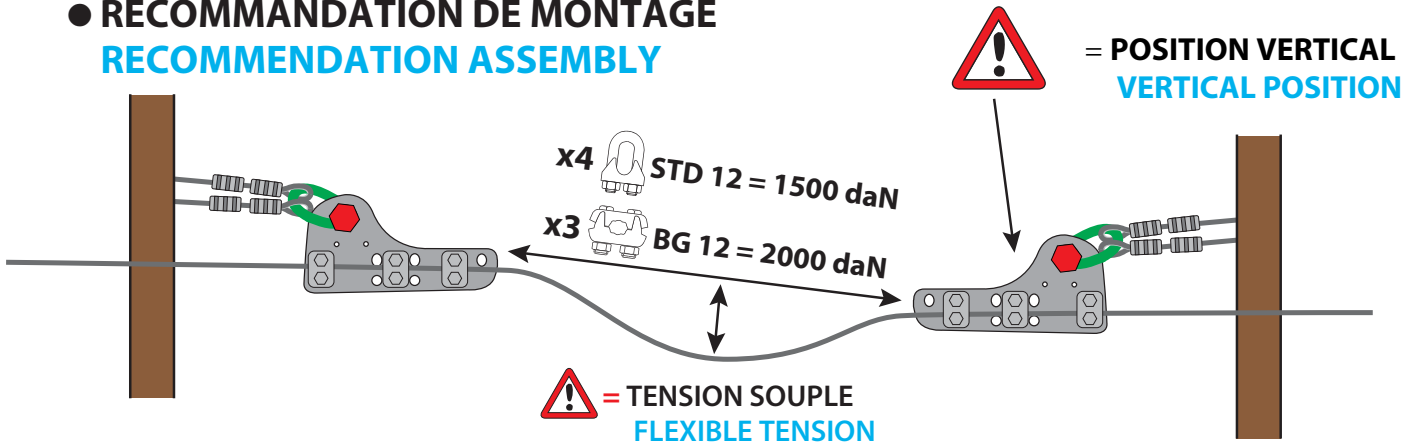

Operation 7

● **JONCTION
JUNCTION**

Exemples (non contractuel)
de systèmes de fixations
**NOT Contractual examples
system of fixing**

